

PRELUDE

— ENGINEERING LLC —

PRELUDE-ENGINEERING.COM

Ash Tray Delete Pocket

Design by Presur Designs



Remove the 2 screws at the rear of the e-brake trim, then slide the trim to the rear until it clears the center console.

Remove the 8 screws holding on the center console, then remove the console:

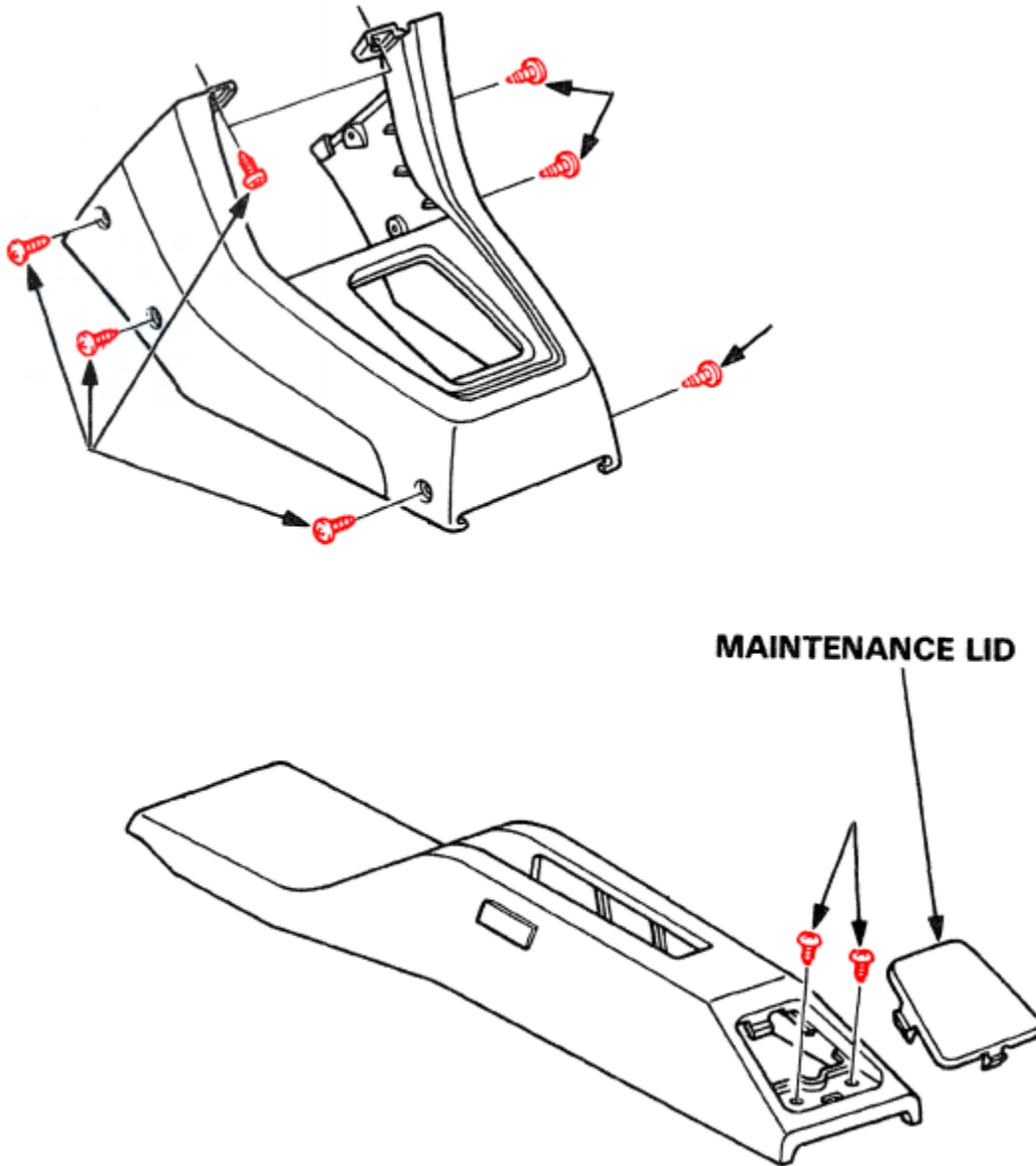

Remove the six machine screws that hold on the radio holder/center trim. Four on the front and one on each side:

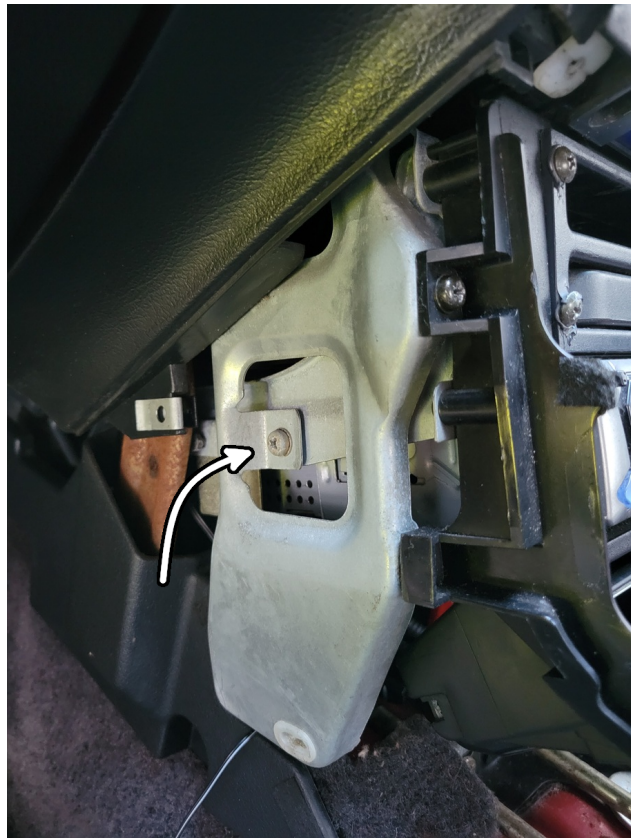

With these removed the whole piece should come out, you will need to disconnect the radio and cigarette lighter connectors.

Turn it around and remove these three screws that secure the ash tray base:

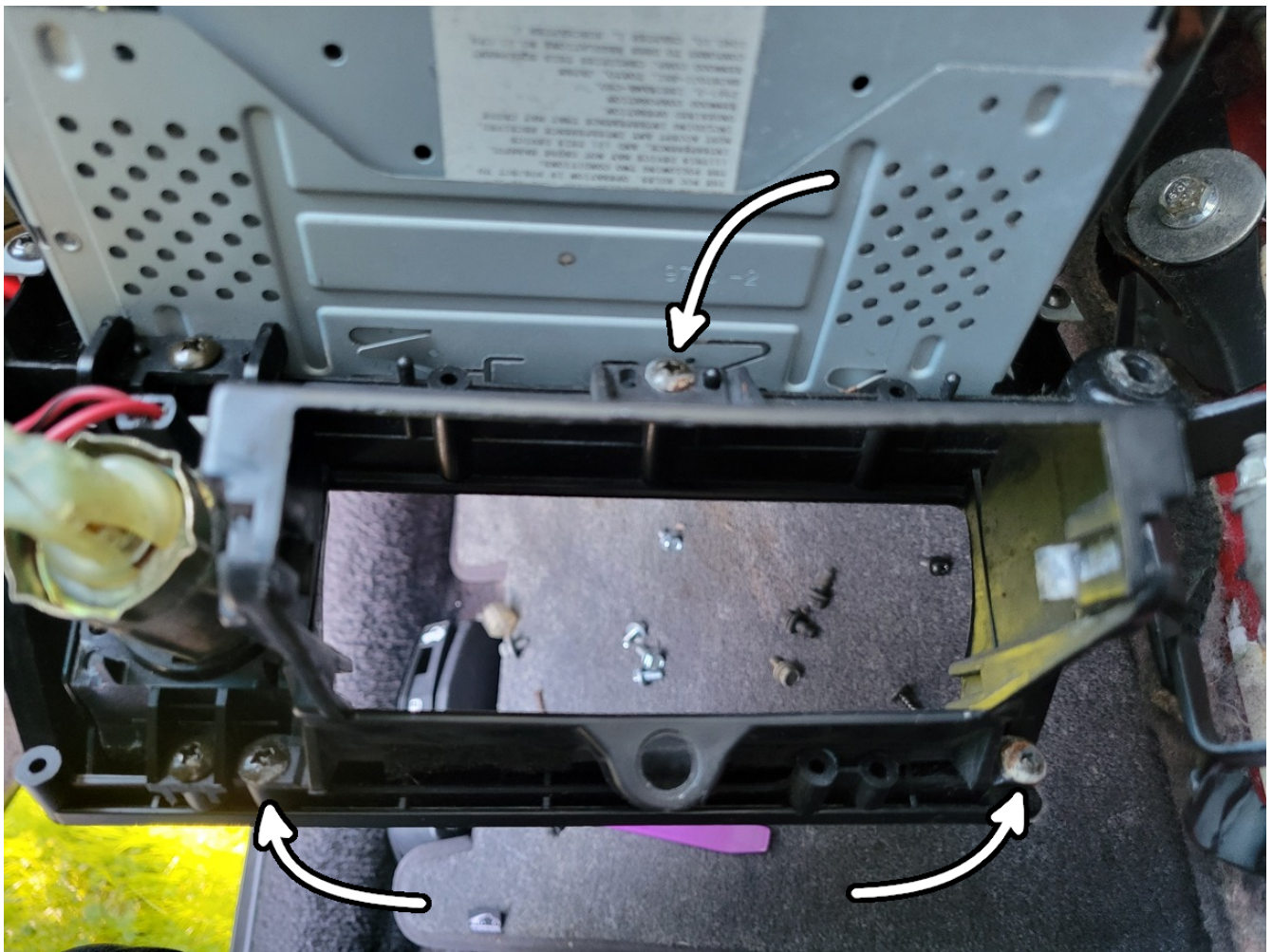

Now you can install the ash tray delete pocket reusing the original screws:

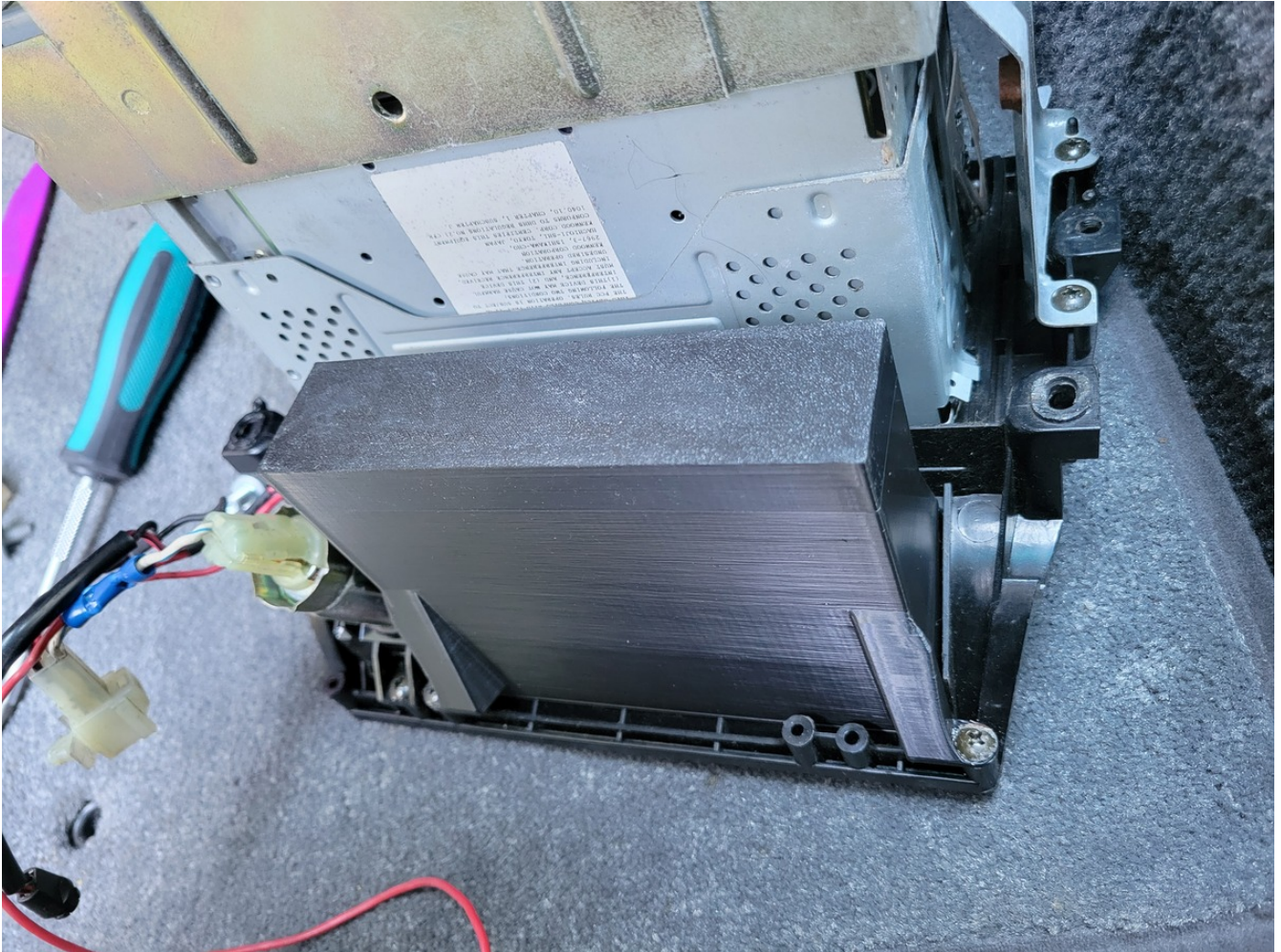

Reinstall everything in reverse order and you are finished.

